

Neighborhood Profile | Oasis Community

People

Population Growth

- In 2010, Oasis Community had 4,171 residents, which is about 3% of Lafayette's population.
- Oasis Community's population increased by 6% from 2000 to 2010, while the city grew by about 9% in the same time frame.

Age Distribution

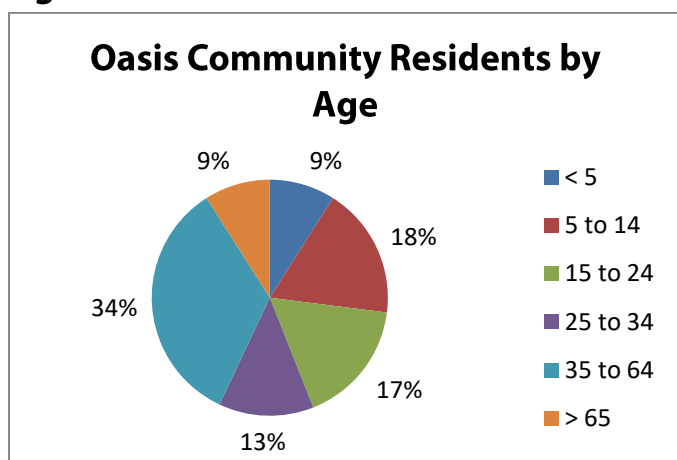

Diversity

- Oasis Community's population is about 7% white and 90% black.
- Lafayette's population, by comparison, is 64% white and 31% black.

Economy

Jobs

- The majority of jobs by industry in Oasis Community fall into the categories of services (62%) and retail (10%).
- When broken down by occupation, Oasis Community's population is 34% white collar, 43% services, and 23% blue collar.

Education

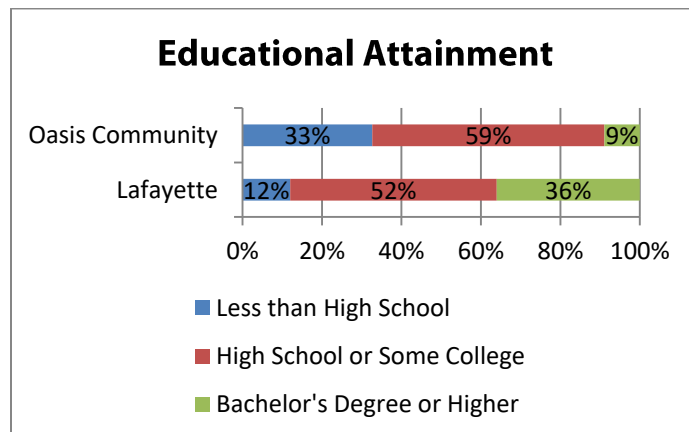

Income

- In 2019, the median household income in Oasis Community was \$23,642, as compared to \$45,029 in Lafayette.

Place

Households

- 99% of Oasis Community's residents live in households, of which 89% are families.

Median Home Value

- In 2019, the median home value in Oasis Community was \$100,622, as compared to \$190,770 in Lafayette.

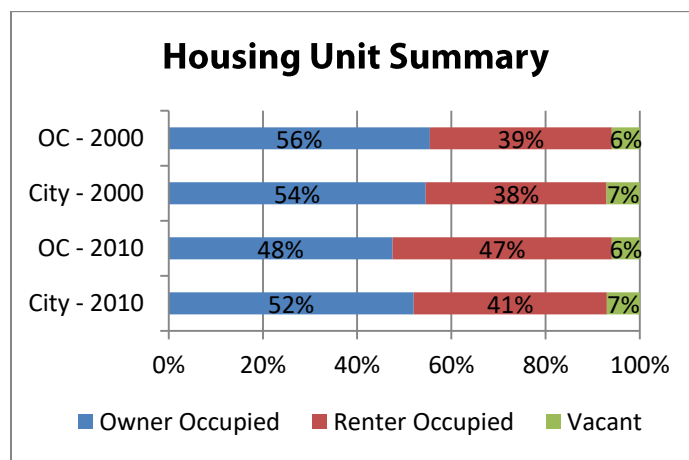

Blight Profile | Oasis Community

Oasis Community Coterie - Adjudicated Properties

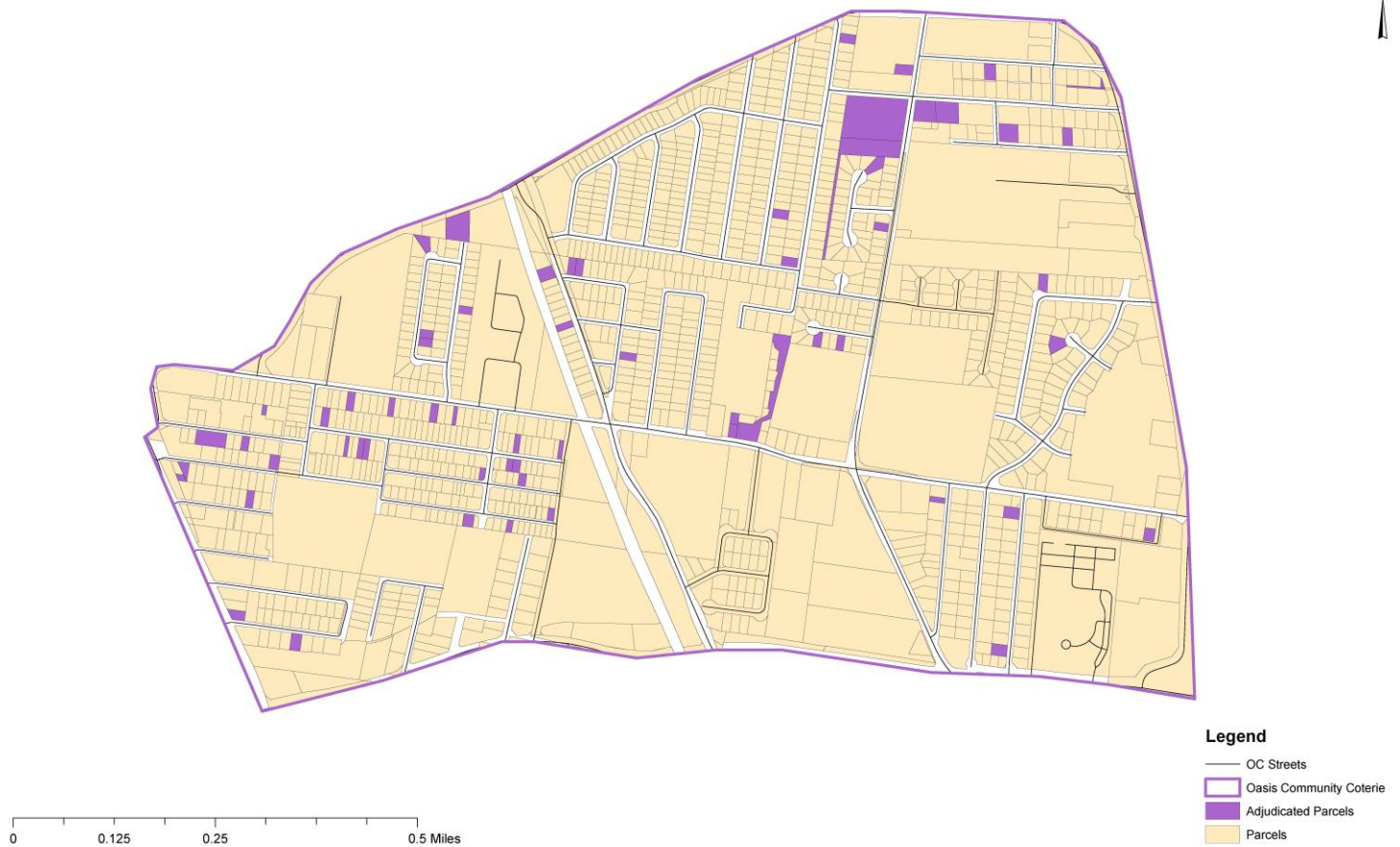

Adjudicated Parcels in Oasis Community

65 Adjudicated Parcels

47 Parcels Adjudicated > 3 Years

18 Parcels Adjudicated < 3 Years

24 Vacant Parcels

21 Potential Heirship Properties

Neighborhood Maps | Oasis Community

Oasis Community Coterie - Zoning

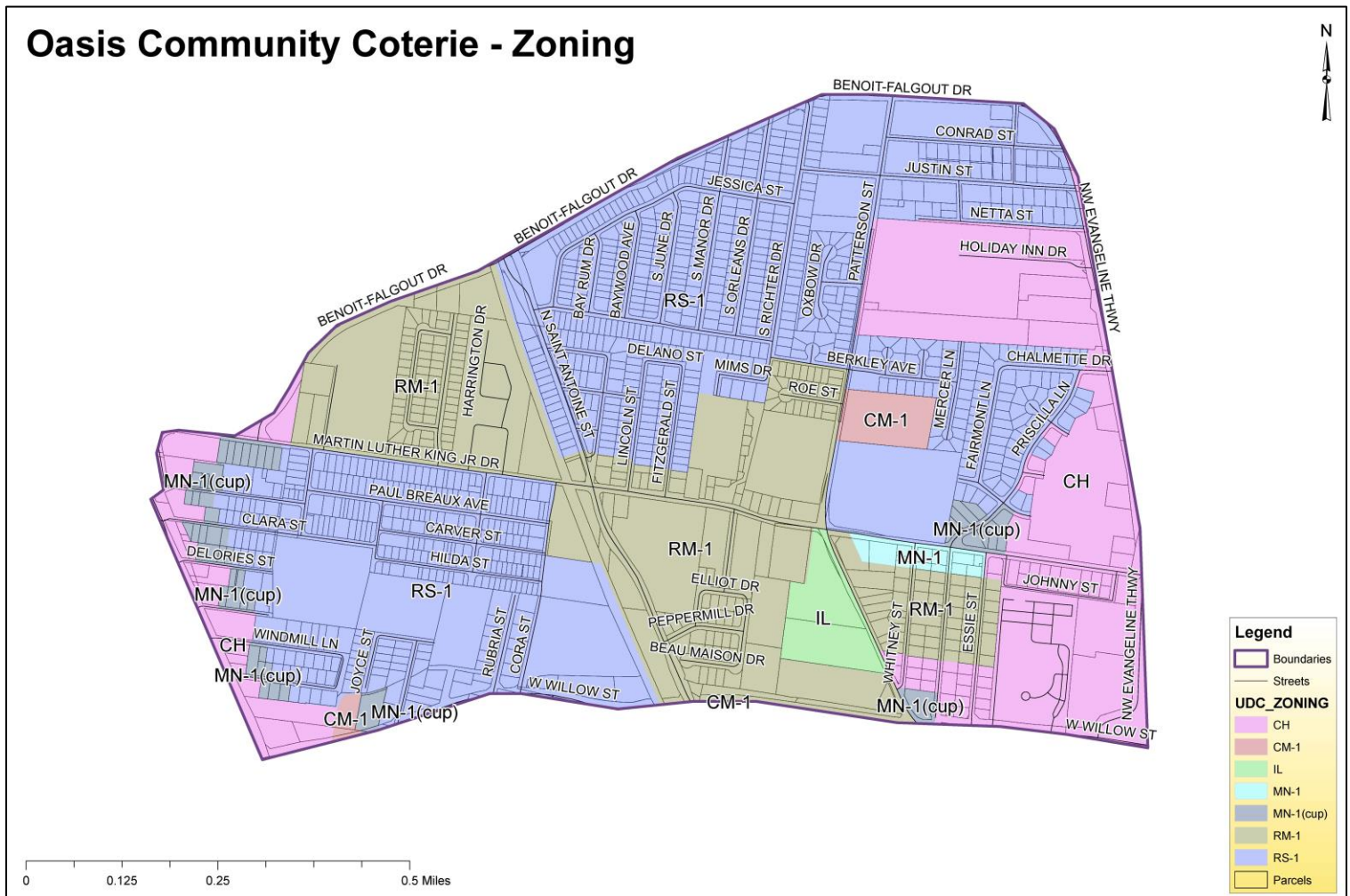

Neighborhood Maps | Oasis Community

Oasis Community Coterie - Land Use

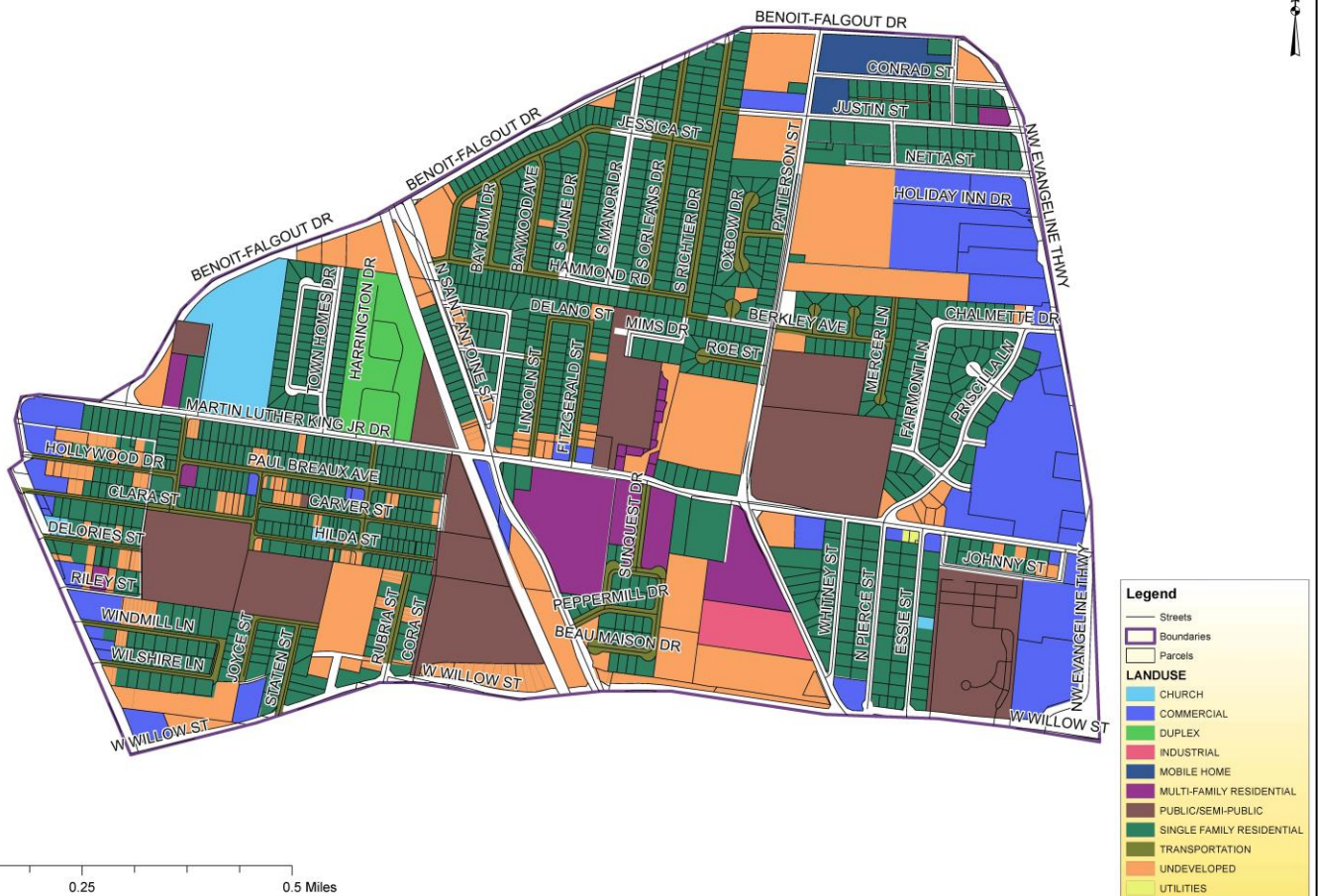

Neighborhood Maps | Oasis Community

Oasis Community Coterie - Contours and Elevations

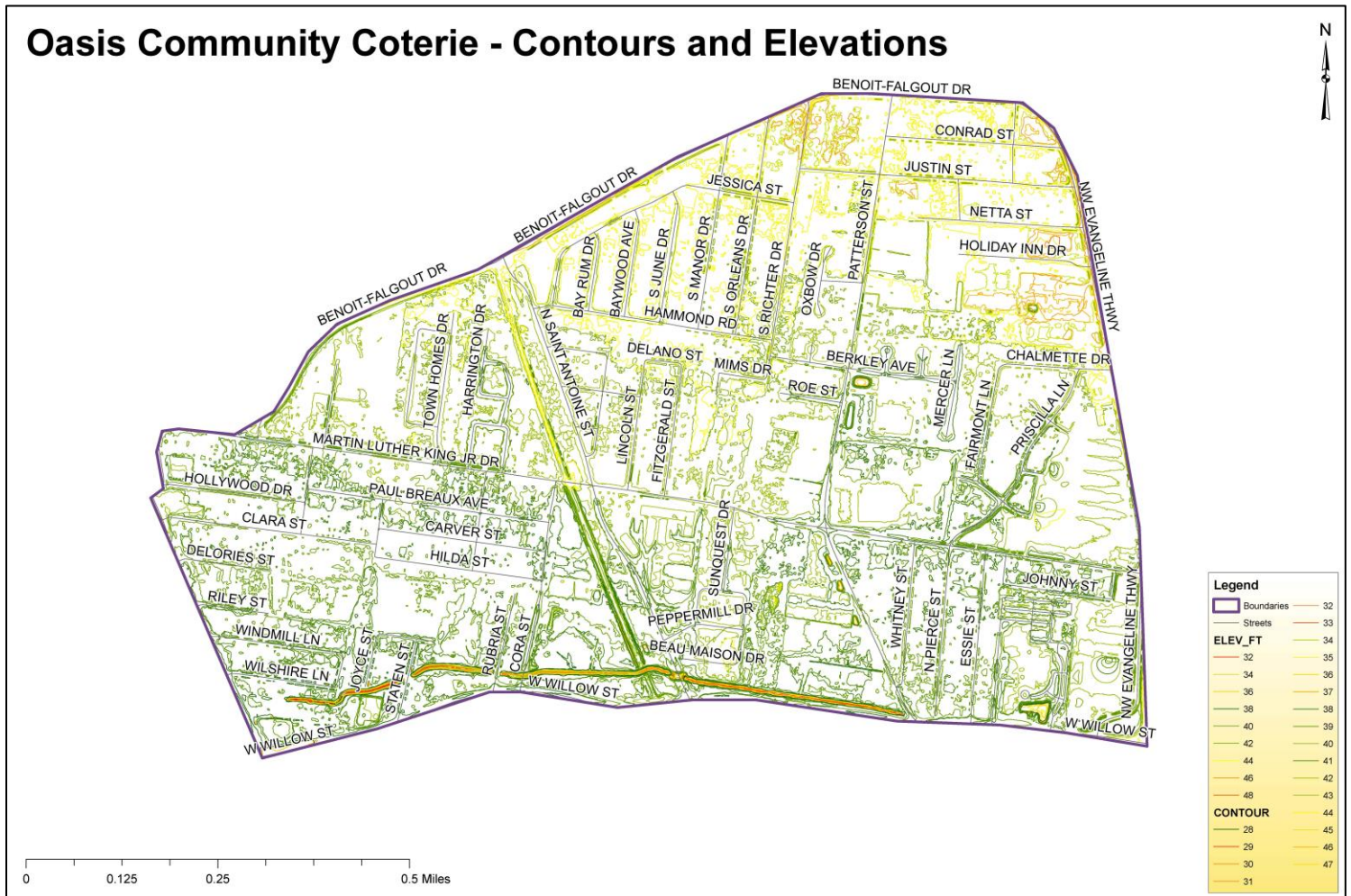

Neighborhood Maps | Oasis Community

Oasis Community Coterie - Bike Infrastructure

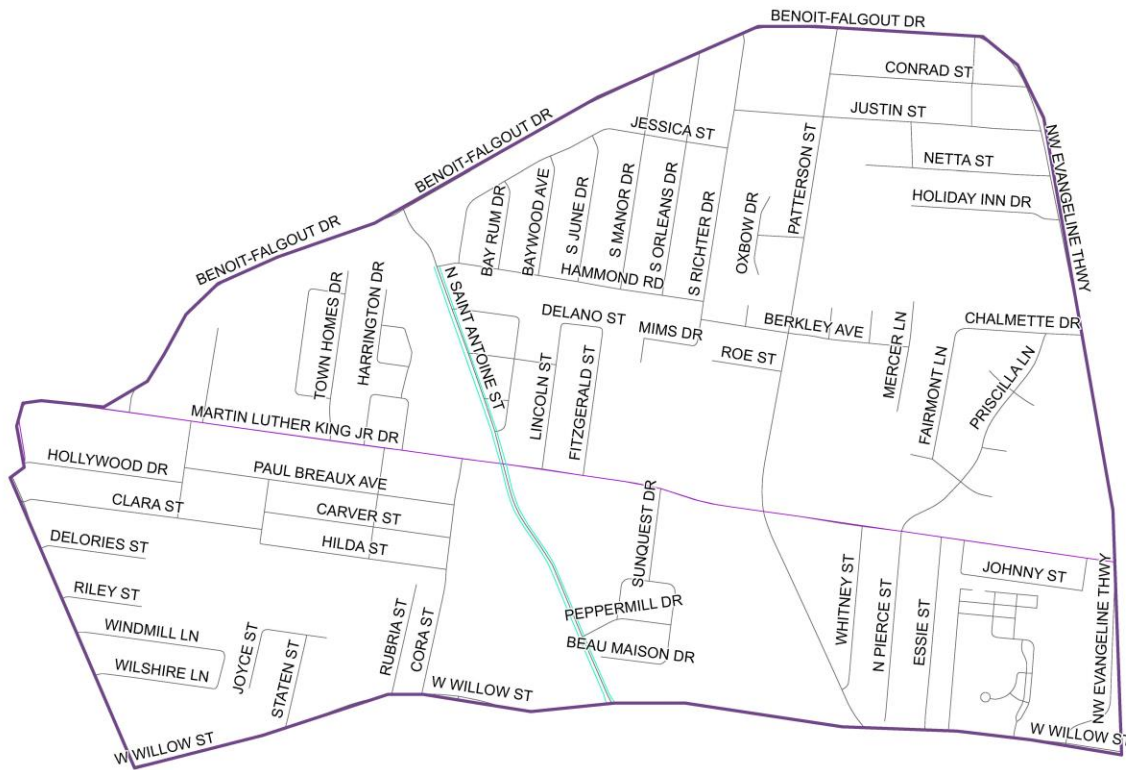

0 0.125 0.25 0.5 Miles