

PLAN

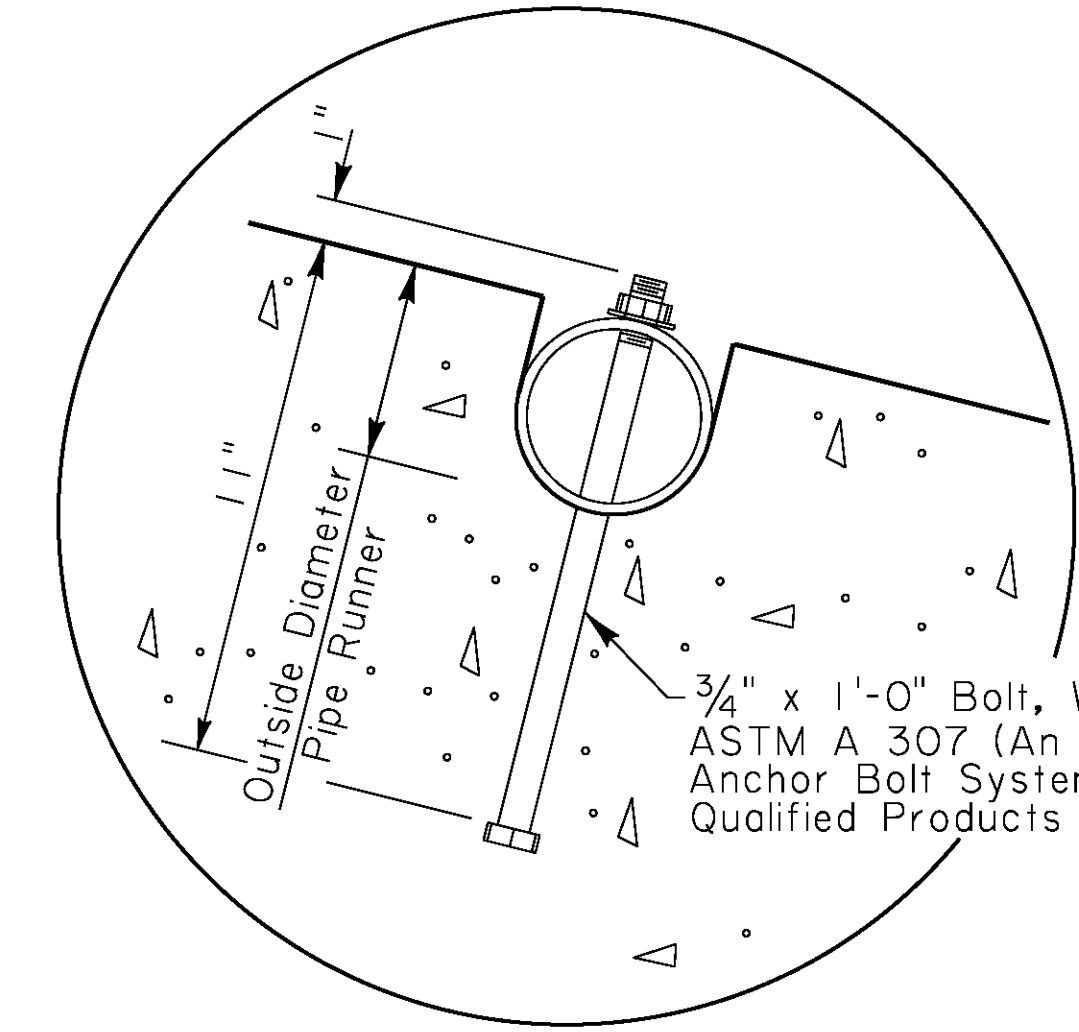

INSET "A"

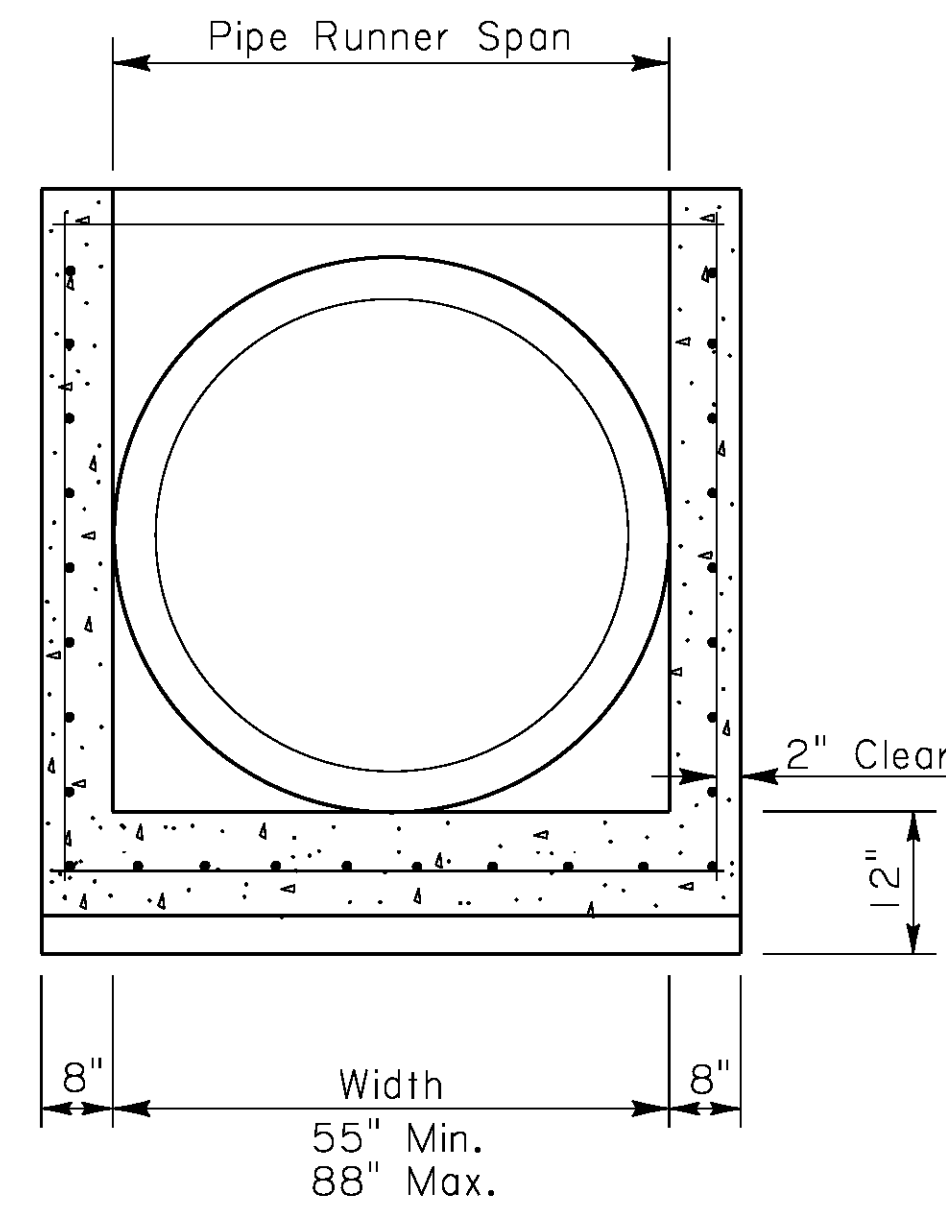

SECTION B-B

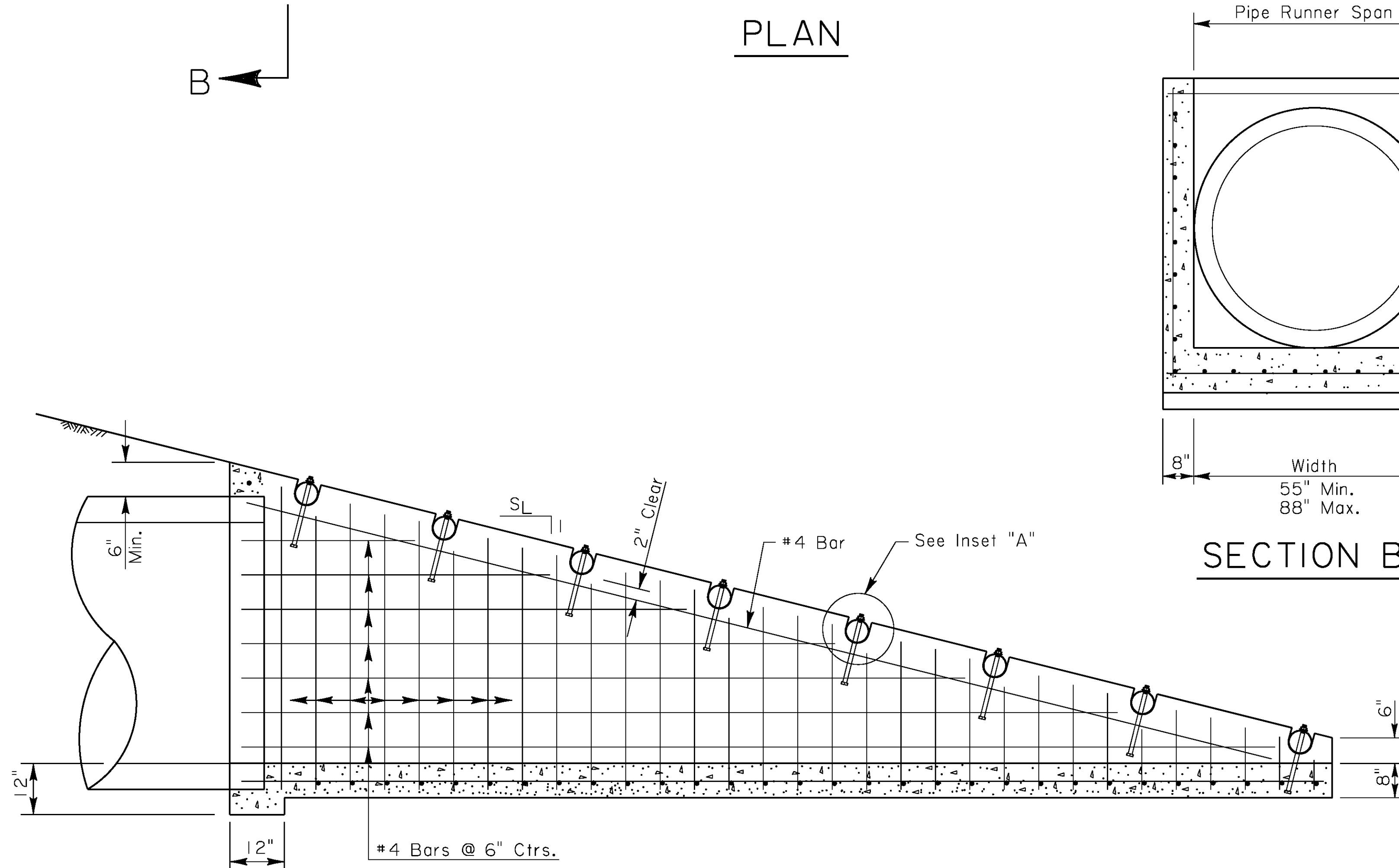

SECTION A-A

General Notes:

- 1) While a RCP culvert is detailed, this Safety End shall also be used with RCPA, ACMP, ACMPA, and RCB culverts. Multiple culverts will require multiple Safety Ends.
- 2) Slope of Safety End walls ($S_L:1$) shall match the required sideslope. If no sideslope is given, a slope of 6:1 shall be required.
- 3) Pipe Runners shall be galvanized steel pipe conforming to ASTM A53, Type E or S, Grade B, 35ksi; or ASTM A501, 36ksi. Required Pipe Runner diameters and strengths for various maximum spans are:

Nominal Diameter	Strength/Schedule	Maximum* Span	Outside Diameter	Wall Thickness	Weight Per Foot
3"	Std/40	11'-2"	3.5"	0.216"	7.58 lbs

* Pipe Runners are designed for a traversing load of 1800 pounds at yield.